

**TECHNICAL
INFORMATION:**

GTX-2875-0065-1001, 2.875 INCH 6.4-6.5 PPF.



CASING O.D. (in)	2.875
CASING WT. (lb/ft)	6.5
CASING I.D. (in)	2.441
PATCH MAX. RUNNING O.D. (in)	2.280
PATCH I.D. AFTER SETTING (in)	1.875
PATCH DRIFT I.D. (in)	1.750
BURST HYDRAULIC RATING (psi)	9000
COLLAPSE HYDRAULIC RATING (psi)	9000
BURST GAS RATING (psi)	8000
COLLAPSE GAS RATING (psi)	8000

QTY.	DESCRIPTION	PART NUMBER	MATERIAL
	GTX-SPAN SYSTEM	GTX-2875-0065-1001	NOTED
4	ELASTOMER	GTX-2875-0065-6000	HSN
1	PIN ELEMENT	GTX-2875-0065-1210	4140 L-80
1	BOX ELEMENT	GTX-2875-0065-1410	4140 L-80
1	TOP SWAGE	GTX-2875-0065-1110	4140
1	BOTTOM SWAGE	GTX-2875-0065-1310	4140
1	O-RING	OOO-V569-135	VITON
1	O-RING	OOO-V569-136	VITON
1	30K SHEAR RING	PAT-2875-048A	STL-12L4-150
1	10 FT. SECTION	PAT-2875-047	L-80
	5 FT. SECTION	PAT-2875-050	L-80

MINIMUM EQUIPMENT REQUIRED FOR A FULL SYSTEM CONSISTS OF ONE SHORT ASSEMBLY AND ONE SECTION.

PRODUCT OFFERINGS:

GTX-SPAN provides a gas tight system to the industry which is effective, reliable, and economical. The system is durable and dependable as an isolation method of perforations, splits, corrossions or leaks in most types of tubulars. This system as well as our current X-SPAN[®] System can be designed using premium alloys for extreme well bore environments and custom sized for most tubing restrictions.

BENEFITS/CAPABILITIES:

- Economical and reliable solution for water shut-off / zonal isolation
- Large bore assures easy passage of service tools
- Minimal surface equipment and one trip system results in savings
- Well interventions may be performed on flowing or static wells
- Easily deployed using a range of pyrotechnic multistage or hydraulic setting tools

**TECHNICAL
INFORMATION:**

GTX-2875-0065-1001, 2.875 INCH 6.4-6.5 PPF.

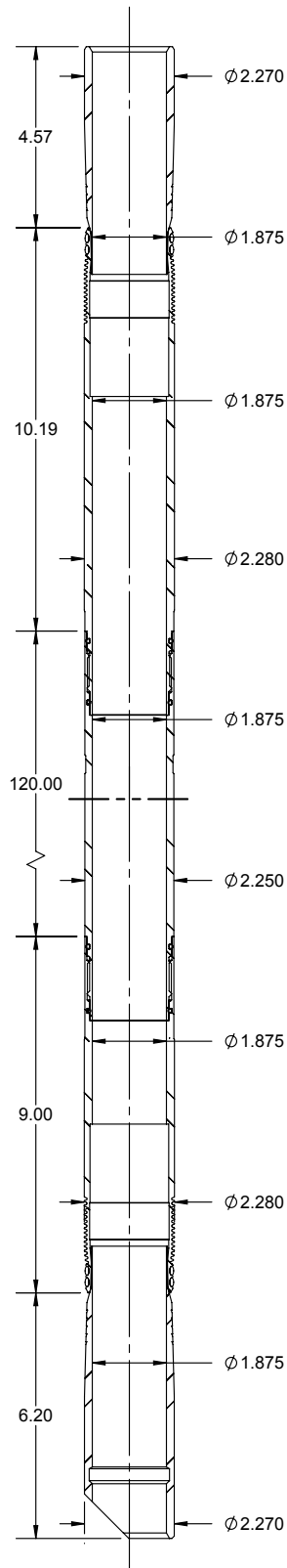

CASING O.D. (in)	2.875
CASING WT. (lb/ft)	6.5
CASING I.D. (in)	2.441
PATCH MAX. RUNNING O.D. (in)	2.280
PATCH I.D. AFTER SETTING (in)	1.875
PATCH DRIFT I.D. (in)	1.750
BURST HYDRAULIC RATING (psi)	9000
COLLAPSE HYDRAULIC RATING (psi)	9000
BURST GAS RATING (psi)	8000
COLLAPSE GAS RATING (psi)	8000

QTY.	DESCRIPTION	PART NUMBER	MATERIAL
4	ELASTOMER	GTX-2875-0065-6000	HSN
1	PIN ELEMENT	GTX-2875-0065-1210	4140 L-80
1	BOX ELEMENT	GTX-2875-0065-1410	4140 L-80
1	TOP SWAGE	GTX-2875-0065-1110	4140
1	BOTTOM SWAGE	GTX-2875-0065-1310	4140
N+1	O-RING	OOO-V569-135	VITON
N+1	O-RING	OOO-V569-136	VITON
1	30K SHEAR RING	PAT-2875-048A	STL-12L4-150
N	10 FT. SECTION	PAT-2875-047	L-80
1	SLEEVE NUT	SET-2125-120	4130 / 4140 / 4142
1	SLEEVE LOCK NUT	SET-2125-121	4130 / 4140 / 4142
1	SETTING SLEEVE	SET-2125-122	4130 / 4140 / 4142
1	QUICK CHANGE ROD	SET-2125-130	4340
1	QUICK CHANGE NUT	SET-2125-131	4340
1	TOP ADAPTER ROD	SET-2125-132	4130 / 4140 / 4142
N+1	ROD TANDEM CONNECTOR	SET-2125-133	4130 / 4140 / 4142
N	10 FT. ROD	SET-2125-134	4130 / 4140 / 4142
OPT	5 FT. ROD	SET-2125-135	4130 / 4140 / 4142
1	BOTTOM ROD	SET-2125-136	4130 / 4140 / 4142
1	COLLET	SET-2125-137	4130 / 4140 / 4142
1	COLLET SUPPORT	SET-2125-140	4130 / 4140 / 4142

MINIMUM EQUIPMENT REQUIRED FOR 10 FT. SYSTEM



EXTENSION SPECIFICATIONS:

GTX-2875-0065-1001, 2.875 INCH 6.4-6.5 PPF.

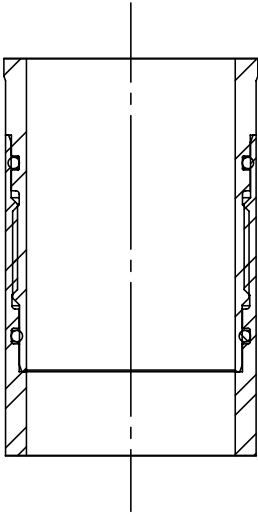

PART NUMBER	LENGTH (INCHES)	OAL (INCHES)	WEIGHT (LBS.)	MATERIAL
PAT-2875-047	120	122.13	40.5	L-80
PAT-2875-050	60	62.13	20.3	L-80

PATCH TENSILE RATING	47,000 LBF
----------------------	------------

SYSTEM WEIGHTS

	WEIGHT (LBS.)
GTX-2875-0065-1001	9.5
10 FT PATCH RUNNING WEIGHT	154.5
EA. ADDITIONAL 10 FT. LGTH ADD	68.7

SETTING TOOL OPTIONS:

HYDRAULIC			WEIGHT (LBS)
SET-2125-100	2-1/8 HYDRAULIC		150
	SCREEN SUB	OT0-798-231A	
	CIRCULATION SUB	SET-2125-200	

PYROTECHNIC			WEIGHT (LBS)
SET-2125-101	2-1/8 MSST		90
	POWER CHARGE	JEC-5334-104	
		JEC-0212-044	
	IGNITER	DET-5306-074	
		DET-5306-008	