

**TECHNICAL INFORMATION:**

**GTX-3500-0093-1001, 3.5 INCH 9.3 PPF**



CASING O.D. (in)	3.500
CASING WT. (lb/ft)	9.3
CASING I.D. (in)	2.922
PATCH MAX. RUNNING O.D. (in)	2.775
PATCH I.D. AFTER SETTING (in)	2.259
PATCH DRIFT I.D. (in)	2.134
BURST HYDRAULIC RATING (psi)	8500
COLLAPSE HYDRAULIC RATING (psi)	9500
BURST GAS RATING (psi)	7000
COLLAPSE GAS RATING (psi)	8000

QTY.	DESCRIPTION	PART NUMBER	MATERIAL
	GTX-SPAN SYSTEM	GTX-3500-0093-1001	NOTED
4	ELASTOMER	GTX-3500-0093-6000	HSN
1	PIN ELEMENT	GTX-3500-0093-1210	4140 L-80
1	BOX ELEMENT	GTX-3500-0093-1410	4140 L-80
1	TOP SWAGE	GTX-3500-0093-1110	4140 L-80
1	BOTTOM SWAGE	GTX-3500-0093-1310	4140 / 4142 L-80
1	O-RING	OOO-V569-142	VITON
1	O-RING	OOO-V569-143	VITON
1	42 - 43K SHEAR RING	PAT-3500-058	1026
1	10 FT. SECTION	GTX-3500-0093-1010	L-80
	5 FT. SECTION	GTX-3500-0093-1005	L-80

MINIMUM EQUIPMENT REQUIRED FOR A FULL SYSTEM CONSISTS OF ONE SHORT ASSEMBLY AND ONE SECTION.

**PRODUCT OFFERINGS:**

GTX-SPAN provides a gas tight system to the industry which is effective, reliable, and economical. The system is durable and dependable as an isolation method of perforations, splits, corruptions or leaks in most types of tubulars. This system as well as our current X-SPAN<sup>®</sup> System can be designed using premium alloys for extreme well bore environments and custom sized for most tubing restrictions.

**BENEFITS/CAPABILITIES:**

- Economical and reliable solution for water shut-off / zonal isolation
- Large bore assures easy passage of service tools
- Minimal surface equipment and one trip system results in savings
- Well interventions may be performed on flowing or static wells
- Easily deployed using a range of pyrotechnic multistage or hydraulic setting tools

**TECHNICAL  
INFORMATION:**

## GTX-3500-0093-1001, 3.5 INCH 9.3 PPF

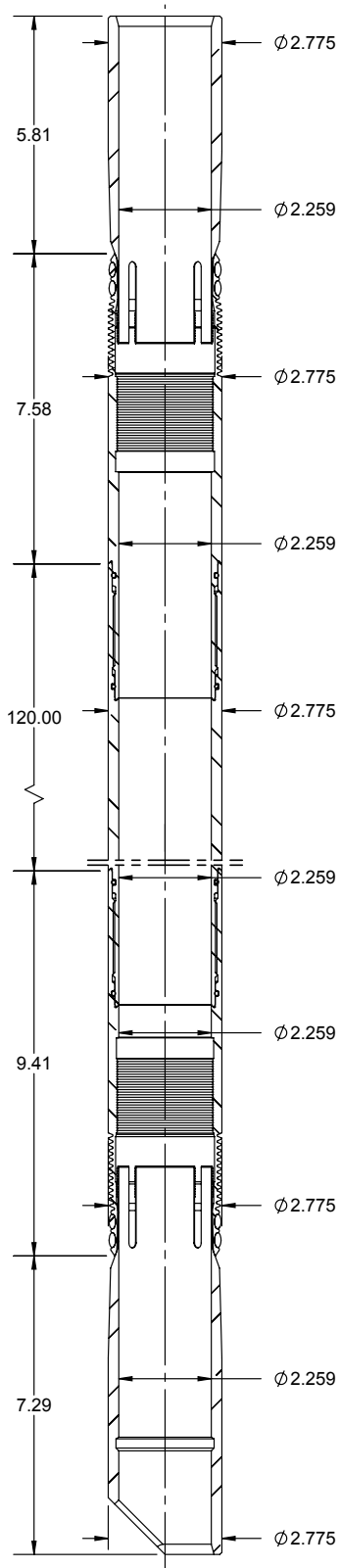

CASING O.D. (in)	3.500
CASING WT. (lb/ft)	9.3
CASING I.D. (in)	2.922
PATCH MAX. RUNNING O.D. (in)	2.775
PATCH I.D. AFTER SETTING (in)	2.259
PATCH DRIFT I.D. (in)	2.134
BURST HYDRAULIC RATING (psi)	8500
COLLAPSE HYDRAULIC RATING (psi)	9500
BURST GAS RATING (psi)	7000
COLLAPSE GAS RATING (psi)	8000

QTY.	PART NUMBER	DESCRIPTION	MATERIAL
4	GTX-3500-0093-6000	ELASTOMER	HSN
1	GTX-3500-0093-1210	PIN ELEMENT	4140 L-80
1	GTX-3500-0093-1410	BOX ELEMENT	4140 L-80
1	GTX-3500-0093-1110	TOP SWAGE	4140 L-80
1	GTX-3500-0093-1310	BOTTOM SWAGE	4140 / 4142 L-80
N+1	OOO-V569-142	O-RING	VITON
N+1	OOO-V569-143	O-RING	VITON
1	PAT-3500-058	42 - 43K SHEAR RING	1026
N	GTX-3500-0093-1010	10 FT. SECTION	L-80
1	SET-2687-130	SLEEVE NUT	4140 / 4142
1	SET-2125-121	SLEEVE LOCK NUT	4130 / 4140 / 4142
1	SET-2125-160	SETTING SLEEVE	4140
1	SET-2125-130	QUICK CHANGE ROD	4340
1	SET-2125-131	QUICK CHANGE NUT	4340
1	SET-2125-132	TOP ADAPTER ROD	4130 / 4140 / 4142
N+1	SET-2125-133	ROD TANDEM CONNECTOR	4130 / 4140 / 4142
N	SET-2125-134	10 FT. ROD	4130 / 4140 / 4142
OPT	SET-2125-135	5 FT. ROD	4130 / 4140 / 4142
1	SET-2125-136	BOTTOM ROD	4130 / 4140 / 4142
1	SET-2125-161	COLLET	4130 / 4140 / 4142
1	SET-2125-155	COLLET SUPPORT	4130 / 4140 / 4142
1	SET-2125-145	RELEASE RING ADAPTER	4130 / 4140 / 4142

MINIMUM EQUIPMENT REQUIRED FOR 10 FT. SYSTEM

**EXTENSION SPECIFICATIONS:**

**GTX-3500-0093-1001, 3.5 INCH 9.3 PPF**

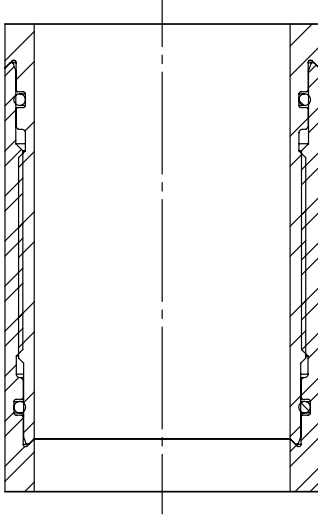

PART NUMBER	LENGTH (INCHES)	OAL (INCHES)	WEIGHT (LBS.)	MATERIAL
GTX-3500-0093-1010	120	123.32	68.1	L-80
GTX-3500-0093-1005	60	63.32	34.05	L-80

PATCH TENSILE RATING	44,000 LBF
----------------------	------------

**SYSTEM WEIGHTS**

	WEIGHT (LBS.)
GTX-3500-0093-1001	13.9
10 FT PATCH RUNNING WEIGHT	132.8
EA. ADDITIONAL 10 FT. LGTH ADD	96.3

**SETTING TOOL OPTIONS:**

HYDRAULIC		WEIGHT (LBS)
SET-2687-200	2-11/16 HYDRAULIC	150
	SCREEN SUB	OTO-798-288A
	CIRCULATION SUB	SET-2875-010
	DUMP SUB	SET-2125-200

PYROTECHNIC		WEIGHT (LBS)
SET-2687-101	2-11/16 MSST	90
	POWER CHARGE	JEC-5334-104
		JEC-0212-044
	IGNITER	DET-5306-074
		DET-5306-008