

TECHNICAL INFORMATION:

GTX-3500-0102-3001, 3.5 INCH 10.2 PPF.



CASING O.D. (in)	3.5
CASING WT. (lb/ft)	10.2
CASING I.D. (in)	2.922
PATCH MAX. RUNNING O.D. (in)	2.767
PATCH I.D. AFTER SETTING (in)	2.250
PATCH DRIFT I.D. (in)	2.125
BURST HYDRAULIC RATING (psi)	10000
COLLAPSE HYDRAULIC RATING (psi)	10000
BURST GAS RATING (psi)	8500
COLLAPSE GAS RATING (psi)	8500

QTY.	DESCRIPTION	PART NUMBER	MATERIAL
	GTX-SPAN SYSTEM	GTX-3500-0102-3001	NOTED
4	ELASTOMER	GTX-3500-0102-6000	HSN
1	PIN ELEMENT	GTX-3500-0102-3210	13 Cr
1	BOX ELEMENT	GTX-3500-0102-3410	13 Cr
1	TOP SWAGE	GTX-3500-0102-3110	SUPER / HYPER CHROME
1	BOTTOM SWAGE	GTX-3500-0102-3310	SUPER / HYPER CHROME
1	O-RING	OOO-V569-142	VITON
1	O-RING	OOO-V569-143	VITON
1	42 - 43K SHEAR RING	PAT-3500-058	1026
1	10 FT SECTION	SPC-3500-0093-2010	L-80
		SPC-3500-0093-3010	13 Cr
	5FT SECTION	SPC-3500-0093-2005	L-80
		SPC-3500-0093-3005	13 Cr
	2 FT SECTION	SPC-3500-0093-2002	L-80
		SPC-3500-0093-3002	13 Cr

MINIMUM REQUIRED EQUIPMENT REQUIRED FOR A FULL SYSTEM CONSISTS OF ONE SHORT ASSEMBLY AND ONE EXTENSION.

PRODUCT OFFERINGS:

GTX-SPAN provides a gas tight system to the industry which is effective, reliable, and economical. The system is durable and dependable as an isolation method of perforations, splits, corrossions or leaks in most types of tubulars. This system as well as our current X-SPAN[®] System can be designed using premium alloys for extreme well bore environments and custom sized for most tubing restrictions.

BENEFITS/CAPABILITIES:

- Economical and reliable solution for water shut-off / zonal isolation
- Large bore assures easy passage of service tools
- Minimal surface equipment and one trip system results in savings
- Well interventions may be performed on flowing or static wells
- Easily deployed using a range of pyrotechnic multistage or hydraulic setting tools

TECHNICAL INFORMATION:

GTX-3500-0102-3001, 3.5 INCH 10.2 PPF.

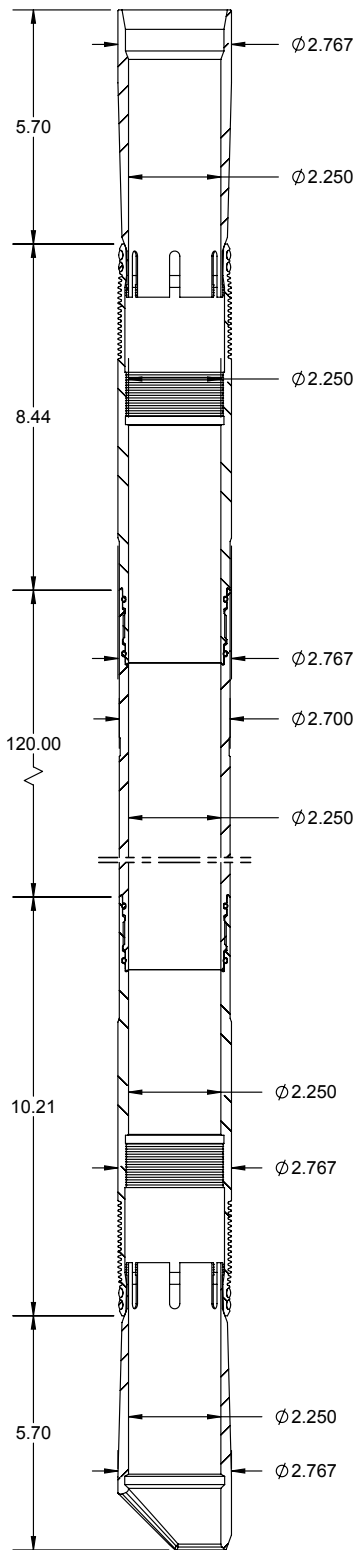

CASING O.D. (in)	3.5
CASING WT. (lb/ft)	10.2
CASING I.D. (in)	2.922
PATCH MAX. RUNNING O.D. (in)	2.767
PATCH I.D. AFTER SETTING (in)	2.250
PATCH DRIFT I.D. (in)	2.125
BURST HYDRAULIC RATING (psi)	10000
COLLAPSE HYDRAULIC RATING (psi)	10000
BURST GAS RATING (psi)	8500
COLLAPSE GAS RATING (psi)	8500

QTY.	DESCRIPTION	PART NUMBER	MATERIAL
4	ELASTOMER	GTX-3500-0102-6000	HSN
1	PIN ELEMENT	GTX-3500-0102-3210	13 Cr
1	BOX ELEMENT	GTX-3500-0102-3410	13 Cr
1	TOP SWAGE	GTX-3500-0102-3110	SUPER / HYPER CHROME
1	BOTTOM SWAGE	GTX-3500-0102-3310	SUPER / HYPER CHROME
N+1	O-RING	OOO-V569-142	VITON
N+1	O-RING	OOO-V569-143	VITON
1	42 - 43K SHEAR RING	PAT-3500-058	1026
N	10 FT SECTION	SPC-3500-0093-2010	L-80
1	SLEEVE NUT	SET-2687-130	4140 / 4142
1	SLEEVE LOCK NUT	SET-2125-121	4130 / 4140 / 4142
1	SETTING SLEEVE	SET-2125-160	4140
1	TOP ADAPTER ROD	SET-2125-132	4130 / 4140 / 4142
N+1	ROD TANDEM CONNECTOR	SET-2125-133	4130 / 4140 / 4142
1	EXTENSION ROD	SET-2125-134	4130 / 4140 / 4142
1	BOTTOM ROD	SET-2125-136	4130 / 4140 / 4142
1	RELEASE RING ADAPTER	SET-2125-145	4130 / 4140 / 4142
1	COLLET	SET-2125-161	4130 / 4140 / 4142
1	COLLET SUPPORT	SET-2125-155	4130 / 4140 / 4142

MINIMUM EQUIPMENT REQUIRED FOR 10 FT. SYSTEM

EXTENSION SPECIFICATIONS:

GTX-3500-0102-3001, 3.5 INCH 10.2 PPF.

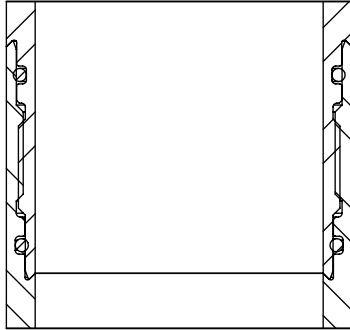

PART NUMBER	LENGTH	OAL	WEIGHT	MATERIAL
SPC-3500-0093-3005	60	61.82	30	13 Cr
SPC-3500-0093-2002	16.5	18.32	9	L-80
SPC-3500-0093-3002	16.5	18.32	9	13 Cr

PATCH TENSILE RATING	40,000 LBF.
----------------------	-------------

SYSTEM WEIGHTS

	WEIGHT (LBS.)
GTX-3500-0102-3001	10
10 FT PATCH RUNNING WEIGHT	121
EA. ADDITIONAL 10 FT. LGTH ADD	88

SETTING TOOL OPTIONS:

HYDRAULIC			WEIGHT (LBS)
2-11/16 HYDRAULIC	SET-2687-200		150
	SCREEN SUB	OTO-798-288A	
	CIRCULATION SUB	SET-2875-010	
	DUMP SUB	SET-2125-200	

PYROTECHNIC			WEIGHT (LBS)
2-11/16 MSST	SET-2687-101		90
	POWER CHARGE	JEC-5334-104	
		JEC-0212-044	
	IGNITER	DET-5306-074	
		DET-5306-008	