

**TECHNICAL
INFORMATION:**

GTX-4500-0126-3001, 4.5 INCH 12.6 PPF



CASING O.D. (in)	4.5
CASING WT. (lb/ft)	12.6
CASING I.D. (in)	3.958
PATCH MAX. RUNNING O.D. (in)	3.718
PATCH I.D. AFTER SETTING (in)	2.992
PATCH DRIFT I.D. (in)	2.867
BURST HYDRAULIC RATING (psi)	5000
COLLAPSE HYDRAULIC RATING (psi)	5000
BURST GAS RATING (psi)	5000
COLLAPSE COLLAPSE RATING (psi)	5000

QTY.	DESCRIPTION	PART NUMBER	MATERIAL
	GTX-SPAN SYSTEM	GTX-4500-0126-3001	NOTED
4	ELASTOMER	GTX-4500-0135-6000	HSN
1	PIN ELEMENT	GTX-4500-0126-3210	13 Cr
1	BOX ELEMENT	GTX-4500-0126-3410	13 Cr
1	TOP SWAGE	GTX-4500-0126-3110	SUPER / HYPER CHROME
1	BOTTOM SWAGE	3GTX-4500-0126-3310	SUPER / HYPER CHROME
1	O-RING	OOO-V569-151	VITON
1	O-RING	OOO-V569-152	VITON
1	72K SHEAR STUD	PAT-4500-772	4140 / 4142
1	10 FT. SECTION	GTX-4500-110	L-80
		GTX-4500-110C	13 Cr
	5 FT. SECTION	GTX-4500-105	L-80
		GTX-4500-105C	13 Cr
	2 FT. SECTION	GTX-4500-102	L-80
		GTX-4500-102C	13 Cr
	20 FT. SECTION	GTX-4500-120	L-80
		GTX-4500-120C	13 Cr

MINIMUM EQUIPMENT REQUIRED FOR A FULL SYSTEM CONSISTS OF ONE SHORT ASSEMBLY AND ONE SECTION.

PRODUCT OFFERINGS:

GTX-SPAN provides a gas tight system to the industry which is effective, reliable, and economical. The system is durable and dependable as an isolation method of perforations, splits, corrossions or leaks in most types of tubulars. This system as well as our current X-SPAN[®] System can be designed using premium alloys for extreme well bore environments and custom sized for most tubing restrictions.

BENEFITS/CAPABILITIES:

- Economical and reliable solution for water shut-off / zonal isolation
- Large bore assures easy passage of service tools
- Minimal surface equipment and one trip system results in savings
- Well interventions may be performed on flowing or static wells
- Easily deployed using a range of pyrotechnic multistage or hydraulic setting tools

TECHNICAL INFORMATION:

GTX-4500-0126-3001, 4.5 INCH 12.6 PPF

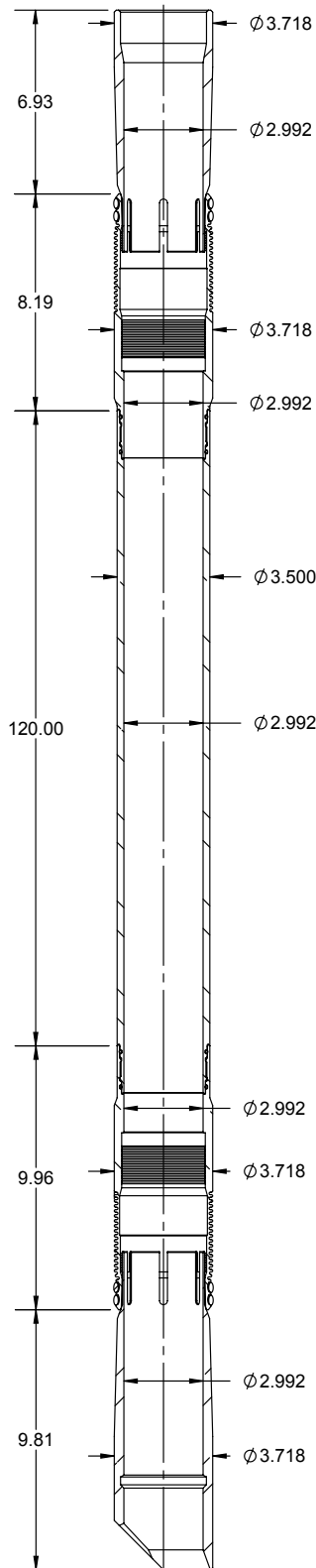

CASING O.D. (in)	4.5
CASING WT. (lb/ft)	12.6
CASING I.D. (in)	3.958
PATCH MAX. RUNNING O.D. (in)	3.718
PATCH I.D. AFTER SETTING (in)	2.992
PATCH DRIFT I.D. (in)	2.867
BURST HYDRAULIC RATING (psi)	5000
COLLAPSE HYDRAULIC RATING (psi)	5000
BURST GAS RATING (psi)	5000
COLLAPSE COLLAPSE RATING (psi)	5000

QTY.	DESCRIPTION	PART NUMBER	MATERIAL
4	ELASTOMER	GTX-4500-0135-6000	HSN
1	PIN ELEMENT	GTX-4500-0126-3210	13 Cr
1	BOX ELEMENT	GTX-4500-0126-3410	13 Cr
1	TOP SWAGE	GTX-4500-0126-3110	SUPER / HYPER CHROME
1	BOTTOM SWAGE	GTX-4500-0126-3310	SUPER / HYPER CHROME
N+1	O-RING	OOO-V569-151	VITON
N+1	O-RING	OOO-V569-152	VITON
1	72K SHEAR RING	PAT-4500-772	4140 / 4142
1	10 FT. SECTION	GTX-4500-110	L-80
1	SET SCREW 1/4 INCH X 20 TPI, 5/16 INCH	PUR-0501-030	ALLOY
1	SLEEVE NUT	SET-3250-420	4140 / 4142
1	SETTING SLEEVE LOCK NUT	SET-3250-421	4140 / 4142
1	SETTING SLEEVE	SET-3250-422	4140 / 4142
1	QUICK CHANGE ROD	SET-3250-130	4130 / 4140
1	QUICK CHANGE NUT	SET-3250-131	4130 / 4140
1	TOP ADAPTER ROD	SET-3250-132	4130 / 4140
N+1	ROD TANDEM CONNECTOR	SET-3250-133	4130 / 4140
N	10 FT. ROD	SET-3250-134	4130 / 4140
OPT.	5 FT. ROD	SET-3250-135	4130 / 4140
1	BOTTOM ROD EXTENDED	SET-3250-136L	4130 / 4140
1	COLLET ASSEMBLY	SET-3250-747	SEE TABLE
1	END SUB	SET-3250-745	4130 / 4140 / 4142
1	COLLET	SET-3250-746	4130 / 4140 / 4142
1	COLLET SUPPORT	SET-3250-446	4140 / 4142
N	ROD SUPPORT	SET-3250-142A	ALUMINIUM

MINIMUM EQUIPMENT REQUIRED FOR 10 FT. SYSTEM

EXTENSION SPECIFICATIONS:

GTX-4500-0126-3001, 4.5 INCH 12.6 PPF

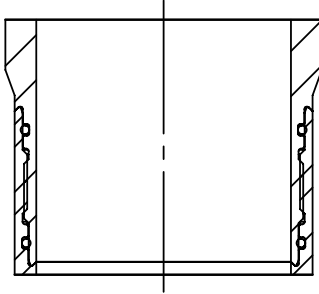

PART NUMBER	LENGTH	OAL	WEIGHT	MATERIAL
GTX-4500-102	24	25.82	17.22	L-80
GTX-4500-102C	24	25.82	17.22	13 Cr
GTX-4500-105	60	61.82	43.16	L-80
GTX-4500-105C	60	61.82	43.16	13 Cr
GTX-4500-110	120	121.82	86.4	L-80
GTX-4500-110C	120	121.82	86.4	13 Cr
GTX-4500-120	240	241.82	172.86	L-80
GTX-4500-120C	240	241.82	172.86	13 Cr

PATCH TENSILE RATING	63,000 LBF
----------------------	------------

SYSTEM WEIGHTS

	WEIGHT (LBS.)
GTX-4500-0126-3001	28.5
10 FT PATCH RUNNING WEIGHT	221.6
EA. ADDITIONAL 10 FT. LGTH ADD	148.4

SETTING TOOL OPTIONS:

HYDRAULIC		WEIGHT (LBS)
3-1/8 INCH HYDRAULIC	SET-3125-010	300
3-1/4 INCH MULTISTAGE SETTING TOOL INTERNALLY STROKED (HYDRAULIC)	SET-3250-410	287
	SCREEN SUB	TT0798-288A
	CIRCULATION SUB	SET-2875-010
	DUMP SUB	OT0710-288B-000

PYROTECHNIC		WEIGHT (LBS)
3-1/4 INCH MULTISTAGE SETTING TOOL	SET-3250-000	206
3-1/4 INCH MULTISTAGE SETTING TOOL INTERNALLY STROKED	SET-3250-400	200
	POWER CHARGE	OPC-3250-000-MS
	IGNITER	DET-5306-074
		DET-5306-008