

**TECHNICAL  
INFORMATION:**

**GTX-4500-0169-3001, 4.5 INCH 16.9 PPF.**



CASING O.D. (in)	4.5
CASING WT. (lb/ft)	16.9
CASING I.D. (in)	3.740
PATCH MAX. RUNNING O.D. (in)	3.560
PATCH I.D. AFTER SETTING (in)	2.750
PATCH DRIFT I.D. (in)	2.625
BURST HYDRAULIC RATING (psi)	9000
COLLAPSE HYDRAULIC RATING (psi)	9000
BURST GAS RATING (psi)	9000
COLLAPSE GAS RATING (psi)	9000

QTY.	DESCRIPTION	PART NUMBER	MATERIAL
	GTX-SPAN SYSTEM	GTX-4500-0169-3001	NOTED
4	ELASTOMER	GTX-4500-0135-6000	HSN
1	PIN ELEMENT	GTX-4500-0169-3210	13 Cr
1	BOX ELEMENT	GTX-4500-0169-3410	13 Cr
1	TOP SWAGE	GTX-4500-0169-3110	SUPER / HYPER 13 CHROME
1	BOTTOM SWAGE	GTX-4500-0169-3310	SUPER / HYPER 13 CHROME
1	O-RING	OOO-V569-151	VITON
1	O-RING	OOO-V569-1515	VITON
1	72K SHEAR RING	PAT-4500-772	4140 / 4142
1	10 FT SECTION	GTX-4500-0169-3010	13 Cr
	5 FT SECTION	GTX-4500-0169-3005	13 Cr

MINIMUM EQUIPMENT REQUIRED FOR A FULL SYSTEM CONSISTS OF ONE SHORT ASSEMBLY AND ONE SECTION.

**PRODUCT OFFERINGS:**

GTX-SPAN provides a gas tight system to the industry which is effective, reliable, and economical. The system is durable and dependable as an isolation method of perforations, splits, corrossions or leaks in most types of tubulars. This system as well as our current X-SPAN<sup>®</sup> System can be designed using premium alloys for extreme well bore environments and custom sized for most tubing restrictions.

**BENEFITS/CAPABILITIES:**

- Economical and reliable solution for water shut-off / zonal isolation
- Large bore assures easy passage of service tools
- Minimal surface equipment and one trip system results in savings
- Well interventions may be performed on flowing or static wells
- Easily deployed using a range of pyrotechnic multistage or hydraulic setting tools

**TECHNICAL INFORMATION:**

**GTX-4500-0169-3001, 4.5 INCH 16.9 PPF.**

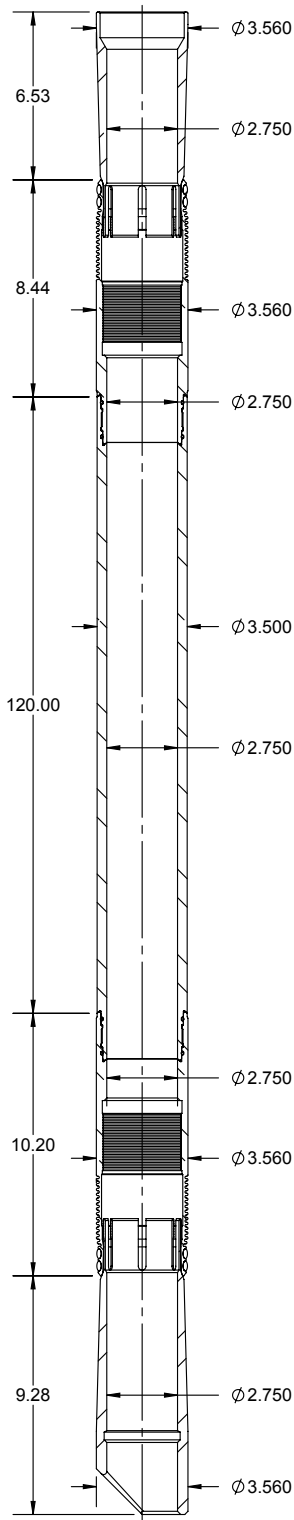

CASING O.D. (in)	4.5
CASING WT. (lb/ft)	16.9
CASING I.D. (in)	3.740
PATCH MAX. RUNNING O.D. (in)	3.560
PATCH I.D. AFTER SETTING (in)	2.750
PATCH DRIFT I.D. (in)	2.625
BURST HYDRAULIC RATING (psi)	9000
COLLAPSE HYDRAULIC RATING (psi)	9000
BURST GAS RATING (psi)	9000
COLLAPSE GAS RATING (psi)	9000

QTY.	DESCRIPTION	PART NUMBER	MATERIAL
4	ELASTOMER	GTX-4500-0135-6000	HSN
1	PIN ELEMENT	GTX-4500-0169-3210	13 Cr
1	BOX ELEMENT	GTX-4500-0169-3410	13 Cr
1	TOP SWAGE	GTX-4500-0169-3110	SUPER / HYPER 13 CHROME
1	BOTTOM SWAGE	GTX-4500-0169-3310	SUPER / HYPER 13 CHROME
N+1	O-RING	OOO-V569-151	VITON
N+1	O-RING	OOO-V569-1515	VITON
1	72K SHEAR RING	PAT-4500-772	4140 / 4142
1	SET SCREW 1/4 INCH X 20 TPI, 5/16 INCH	PUR-0501-030	ALLOY
N	10 FT SECTION	GTX-4500-0169-3010	13 Cr
1	SLEEVE NUT	SET-3250-420	4140 / 4142
1	SETTING SLEEVE LOCK NUT	SET-3250-421	4140 / 4142
1	SETTING SLEEVE	SET-3250-411A	4140 / 4130 / 4142
1	QUICK CHANGE ROD	SET-3250-130	4130 / 4140
1	QUICK CHANGE NUT	SET-3250-131	4130 / 4140
1	TOP ADAPTER ROD	SET-3250-132	4130 / 4140
N+1	ROD TANDEM CONNECTOR	SET-3250-133	4130 / 4140
N	10 FT. ROD	SET-3250-134	4130 / 4140
OPT	5 FT. ROD	SET-3250-135	4130 / 4140
1	BOTTOM ROD EXTENDED	SET-3250-136L	4130 / 4140
1	COLLET ASSEMBLY	SET-3250-757	SEE TABLE
1	END SUB	SET-3250-755	4130 / 4140 / 4142
1	COLLET	SET-3250-756	4130 / 4140 / 4142
1	COLLET SUPPORT	SET-3250-446S	4140 / 4142
N	ROD SUPPORT	SET-3250-142B	4140 / 4142

MINIMUM EQUIPMENT REQUIRED FOR 10 FT. SYSTEM

**EXTENSION SPECIFICATIONS:**

**GTX-4500-0169-3001, 4.5 INCH 16.9 PPF.**

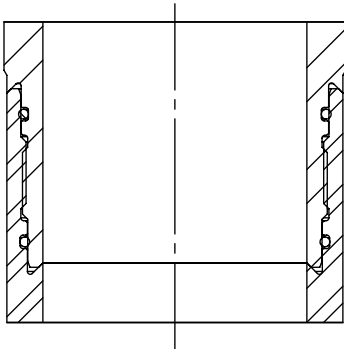

PART NUMBER	LENGTH	OAL	WEIGHT	MATERIAL
GTX-4500-0169-3005	60	61.82	62.14	13 Cr
GTX-4500-0169-3010	120	121.82	124.38	13 Cr

PATCH TENSILE RATING	105,000 LBF.
----------------------	--------------

**SYSTEM WEIGHTS**

SYSTEM WEIGHTS	WEIGHT (LBS.)
GTX-4500-0169-3001	25
10 FT PATCH RUNNING WEIGHT	260.23
EA. ADDITIONAL 10 FT. LGTH ADD	183.82

**SETTING TOOL OPTIONS:**

HYDRAULIC			WEIGHT (LBS)
3-1/8 INCH HYDRAULIC	SET-3125-010		300
	SCREEN SUB	TT0798-288A	
	CIRCULATION SUB	SET-2875-010	
	DUMP SUB	OT0710-288B-000	

PYROTECHNIC			WEIGHT (LBS)
3-1/4 INCH MULTISTAGE SETTING TOOL	SET-3250-000		206
	BOTTOM ADAPTER	SET-3250-431	
	POWER CHARGE	OPC-3250-000-MS	
	IGNITER	DET-5306-074	
		DET-5306-008	