

**TECHNICAL INFORMATION:**

## GTX-5500-0155-1001, 5.5 INCH 15.5 PPF



CASING O.D. (in)	5.500
CASING WT. (lb/ft)	15.5
CASING I.D. (in)	4.950
PATCH MAX. RUNNING O.D. (in)	4.790
PATCH I.D. AFTER SETTING (in)	3.920
PATCH DRIFT I.D. (in)	3.795
BURST HYDRAULIC RATING (psi)	5220
COLLAPSE HYDRAULIC RATING (psi)	5800
BURST GAS RATING (psi)	5220
COLLAPSE COLLAPSE RATING (psi)	5800

QTY.	DESCRIPTION	PART NUMBER	MATERIAL
1	GTX-SPAN SYSTEM	GTX-5500-0155-1001	NOTED
4	ELASTOMER	GTX-5500-0155-6000	HSN
1	PIN ELEMENT	GTX-5500-0155-1210	4140
1	BOX ELEMENT	GTX-5500-0155-1410	4140
1	TOP SWAGE	GTX-5500-0155-1110	4140 / 4142
1	BOTTOM SWAGE	GTX-5500-0155-1310	4140 / 4142
1	60 K SHEAR RING	PAT-4500-047	4140
1	O-RING	OOO-V569-155	VITON
1	O-RING	OOO-V569-156	VITON
1	10 FT SECTION	GTX-5500-0155-1010	L-80
-		GTX-5500-0155-3010	13 Cr
-	5 FT SECTION	GTX-5500-0155-1005	L-80
-		GTX-5500-0155-3005	13 Cr
-	20 FT SECTION	GTX-5500-0155-1020	L-80
-		GTX-5500-0155-3020	13 Cr

MINIMUM EQUIPMENT REQUIRED FOR A FULL SYSTEM CONSISTS OF ONE SHORT ASSEMBLY AND ONE SECTION.

### PRODUCT OFFERINGS:

GTX-SPAN provides a gas tight system to the industry which is effective, reliable, and economical. The system is durable and dependable as an isolation method of perforations, splits, corrossions or leaks in most types of tubulars. This system as well as our current X-SPAN<sup>®</sup> System can be designed using premium alloys for extreme well bore environments and custom sized for most tubing restrictions.

### BENEFITS/CAPABILITIES:

- Economical and reliable solution for water shut-off / zonal isolation
- Large bore assures easy passage of service tools
- Minimal surface equipment and one trip system results in savings
- Well interventions may be performed on flowing or static wells
- Easily deployed using a range of pyrotechnic multistage or hydraulic setting tools

**TECHNICAL  
INFORMATION:**

## GTX-5500-0155-1001, 5.5 INCH 15.5 PPF

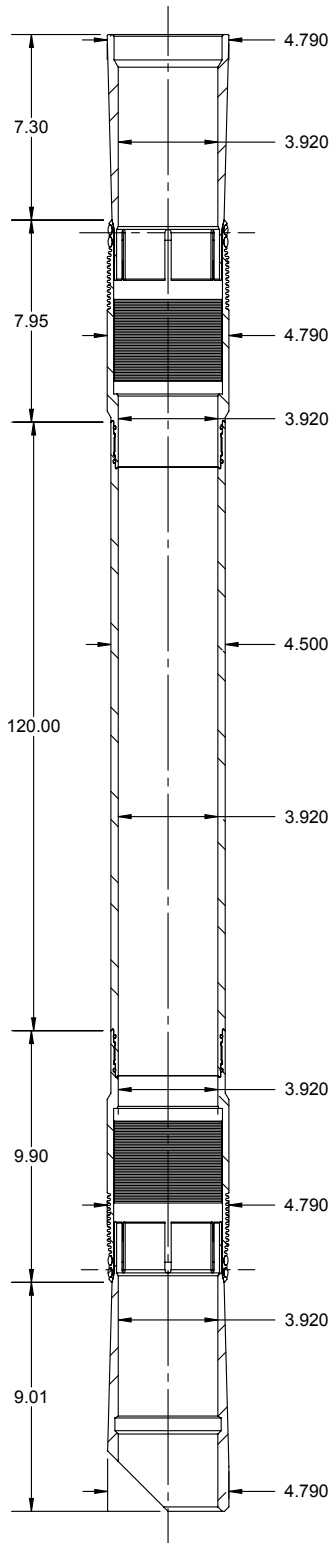

CASING O.D. (in)	5.500
CASING WT. (lb/ft)	15.5
CASING I.D. (in)	4.950
PATCH MAX. RUNNING O.D. (in)	4.790
PATCH I.D. AFTER SETTING (in)	3.920
PATCH DRIFT I.D. (in)	3.795
BURST HYDRAULIC RATING (psi)	5220
COLLAPSE HYDRAULIC RATING (psi)	5800
BURST GAS RATING (psi)	5220
COLLAPSE COLLAPSE RATING (psi)	5800

QTY.	DESCRIPTION	PART NUMBER	MATERIAL
4	ELASTOMER	GTX-5500-0155-6000	HSN
1	PIN ELEMENT	GTX-5500-0155-1210	4140
1	BOX ELEMENT	GTX-5500-0155-1410	4140
1	TOP SWAGE	GTX-5500-0155-1110	4140 / 4142
1	BOTTOM SWAGE	GTX-5500-0155-1310	4140 / 4142
N+1	O-RING	OOO-V569-155	VITON
N+1	O-RING	OOO-V569-156	VITON
1	SET SCREW 1/4 INCH X 20 TPI, 5/16 INCH	PUR-0501-030	ALLOY
1	60 K SHEAR RING	PAT-4500-047	4140
N	10 FT SECTION	GTX-5500-0155-1010	L-80
1	SLEEVE NUT	SET-3250-120	4130 / 4140
1	SLEEVE LOCK NUT	SET-3250-121	4130 / 4140
1	SETTING SLEEVE	SET-3250-262	4140 / 4142
1	QUICK CHANGE ROD	SET-3250-130	4130 / 4140
1	QUICK CHANGE NUT	SET-3250-131	4130 / 4140
1	LOCK NUT	SET-3500-025	1213 / 1215
1	TOP ADAPTER ROD	SET-3250-132	4130 / 4140
N+1	ROD TANDEM CONNECTOR	SET-3250-133	4130 / 4140
N	10 FT. ROD	SET-3250-134	4130 / 4140
OPT	5 FT. ROD	SET-3250-135	4130 / 4140
1	BOTTOM ROD	SET-3250-136	4130 / 4140
1	COLLET ASSEMBLY	SET-3250-261	NOTED
1	COLLET	SET-3250-259	4130 / 4140 / 4142
1	END SUB	SET-3250-156	4130 / 4140
1	COLLET SUPPORT	SET-3250-164	4130 / 4140
N	ROD SUPPORT	SET-3250-160	ALUMINIUM

MINIMUM EQUIPMENT REQUIRED FOR 10 FT. SYSTEM

### EXTENSION SPECIFICATIONS:

### GTX-5500-0155-1001, 5.5 INCH 15.5 PPF

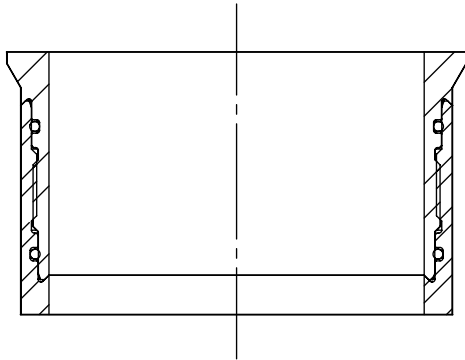

PART NUMBER	LENGTH (INCHES)	OAL (INCHES)	WEIGHT (LBS.)	MATERIAL
GTX-5500-0155-1005	60	61.82	64.0	L-80
GTX-5500-0155-3005	60	61.82	64.0	13 Cr
GTX-5500-0155-1010	120	121.82	128.0	L-80
GTX-5500-0155-3010	120	121.82	128.0	13 Cr
GTX-5500-0155-1020	240	241.82	256.0	L-80
GTX-5500-0155-3020	240	241.82	256.0	13 Cr

PATCH TENSILE RATING	104,000 LBF
----------------------	-------------

### SYSTEM WEIGHTS

	WEIGHT (LBS.)
GTX-5500-0155-1001	39.0
10 FT PATCH RUNNING WEIGHT	286.8
EA. ADDITIONAL 10 FT. LGTH ADD	190.0

### SETTING TOOL OPTIONS:

HYDRAULIC			WEIGHT (LBS)
4-1/2 INCH HYDRAULIC	SET-4500-010		880
3-1/8 INCH HYDRAULIC	SET-3125-010		300
3-1/4 INCH MULTISTAGE SETTING TOOL INTERNALLY STROKED (HYDRAULIC)	SET-3250-410		287
	SCREEN SUB	TT0798-288A	
	CIRCULATION SUB	SET-2875-010	
	DUMP SUB	OT0710-288B-000	

PYROTECHNIC			WEIGHT (LBS)
3-1/4 INCH MULTISTAGE SETTING TOOL	SET-3250-000		206
3-1/4 INCH MULTISTAGE SETTING TOOL INTERNALLY STROKED	SET-3250-400		200
	POWER CHARGE	OPC-3250-000-MS	
	IGNITER	DET-5306-074	
		DET-5306-008	