

TECHNICAL INFORMATION:

GTX-5500-0170-3001, 5.5 INCH 17 PPF



CASING O.D. (in)	5.5
CASING WT. (lb/ft)	17
CASING I.D. (in)	4.892
PATCH MAX. RUNNING O.D. (in)	4.532
PATCH I.D. AFTER SETTING (in)	3.810
PATCH DRIFT I.D. (in)	3.685
BURST HYDRAULIC RATING (psi)	6000
COLLAPSE HYDRAULIC RATING (psi)	7500
BURST GAS RATING (psi)	5500
COLLAPSE COLLAPSE RATING (psi)	6000

QTY.	DESCRIPTION	PART NUMBER	MATERIAL
	GTX-5500-0170-3001	GTX-SPAN SYSTEM	NOTED
4	GTX-5500-0230-6000	ELASTOMER	HSN
1	GTX-5500-0170-3210	PIN ELEMENT	13 CR
1	GTX-5500-0170-3410	BOX ELEMENT	13 CR
1	GTX-5500-0170-3110	TOP SWAGE	SUPER / HYPER CHROME
1	GTX-5500-0170-3310	BOTTOM SWAGE	SUPER/HYPER CHROME
1	OOO-V569-155	O-RING	VITON
1	OOO-V569-156	O-RING	VITON
1	PAT-4500-038	72K SHEAR STUD	4140/4142
1	GTX-5500-0155-1010	10 FT SECTION	L-80
	GTX-5500-0155-3010		13 Cr
	GTX-5500-0155-1005	5 FT SECTION	L-80
	GTX-5500-0155-3005		13 Cr
	GTX-5500-0155-1020	20 FT SECTION	L-80
	GTX-5500-0155-3020		13 Cr
	GTX-5500-0155-1002	2 FT SECTION	L-80
	GTX-5500-0155-3002		13 Cr

MINIMUM EQUIPMENT REQUIRED FOR A FULL SYSTEM CONSISTS OF ONE SHORT ASSEMBLY AND ONE SECTION.

PRODUCT OFFERINGS:

GTX-SPAN provides a gas tight system to the industry which is effective, reliable, and economical. The system is durable and dependable as an isolation method of perforations, splits, corrossions or leaks in most types of tubulars. This system as well as our current X-SPAN[®] System can be designed using premium alloys for extreme well bore environments and custom sized for most tubing restrictions.

BENEFITS/CAPABILITIES:

- Economical and reliable solution for water shut-off / zonal isolation
- Large bore assures easy passage of service tools
- Minimal surface equipment and one trip system results in savings
- Well interventions may be performed on flowing or static wells
- Easily deployed using a range of pyrotechnic multistage or hydraulic setting tools

TECHNICAL
INFORMATION:

GTX-5500-0170-3001, 5.5 INCH 17 PPF

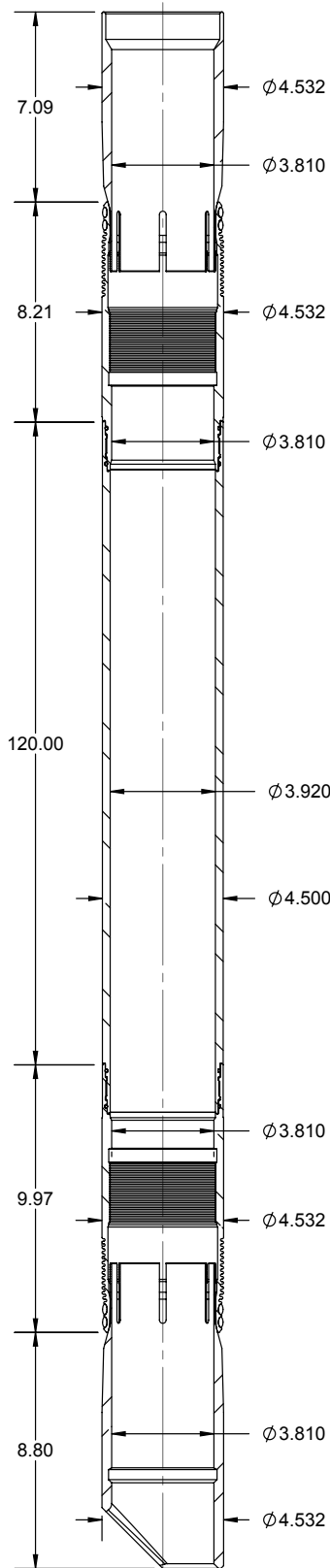

CASING O.D. (in)	5.5
CASING WT. (lb/ft)	17
CASING I.D. (in)	4.892
PATCH MAX. RUNNING O.D. (in)	4.532
PATCH I.D. AFTER SETTING (in)	3.810
PATCH DRIFT I.D. (in)	3.685
BURST HYDRAULIC RATING (psi)	6000
COLLAPSE HYDRAULIC RATING (psi)	7500
BURST GAS RATING (psi)	5500
COLLAPSE COLLAPSE RATING (psi)	6000

QTY.	DESCRIPTION	PART NUMBER	MATERIAL
4	ELASTOMER	GTX-5500-0230-6000	HSN
1	PIN ELEMENT	GTX-5500-0170-3210	13 CR
1	BOX ELEMENT	GTX-5500-0170-3410	13 CR
1	TOP SWAGE	GTX-5500-0170-3110	SUPER / HYPER CHROME
1	BOTTOM SWAGE	GTX-5500-0170-3310	SUPER / HYPER CHROME
N+1	O-RING	OOO-V569-155	VITON
N+1	O-RING	OOO-V569-156	VITON
1	SET SCREW 1/4 INCH X 20 TPI, 5/16 INCH	PUR-0501-030	ALLOY
1	72K SHEAR STUD	PAT-4500-038	4140/4142
N	EXTENSION	GTX-5500-0155-1010	4.5 X 3.920
1	SLEEVE NUT	SET-3250-120	4140/4130
1	SLEEVE LOCK NUT	SET-3250-121	4140/4130
1	SETTING SLEEVE	SET-3250-262	4140-4142
1	QUICK CHANGE ROD	SET-3250-130	4130/4140
1	QUICK CHANGE NUT	SET-3250-131	4130/4140
1	TOP ADAPTER ROD	SET-3250-132	4130/4140
N+1	ROD TANDEM CONNECTOR	SET-3250-133	4140/4130
N	10 FT. ROD	SET-3250-134	4140 / 4130
OPT	5 FT. ROD	SET-3250-135	4140 / 4130
1	BOTTOM ROD EXTENDED	SET-3250-136L	4140/4130
1	COLLET ASSEMBLY	SET-3250-137B	NOTED
1	COLLET BODY	SET-3250-138B	4140 / 4142
1	END SUB	SET-3250-139B	4140 / 4142
1	COLLET SUPPORT	SET-3250-157C	4130 / 4140
1	ROD SUPPORT	SET-3250-160	ALUMINIUM

MINIMUM EQUIPMENT REQUIRED FOR 10 FT. SYSTEM

EXTENSION SPECIFICATIONS:

GTX-5500-0170-3001, 5.5 INCH 17 PPF

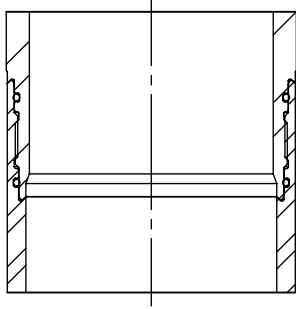

PART NUMBER	LENGTH	OAL	WEIGHT	MATERIAL
GTX-5500-0155-1010	120	121.8	130	L-80
GTX-5500-0155-3010	120	121.8	130	13 Cr
GTX-5500-0155-1005	60	61.8	65	L-80
GTX-5500-0155-3005	60	61.8	65	13 Cr
GTX-5500-0155-1020	240	241.8	260	L-80
GTX-5500-0155-3020	240	241.8	260	13 Cr
GTX-5500-0155-1002	24	25.8	26	L-80
GTX-5500-0155-3002	24	25.8	26	13 Cr

PATCH TENSILE RATING	104,000 LBF
----------------------	-------------

SYSTEM WEIGHTS

	WEIGHT (LBS.)
GTX-5500-0170-3001	37.38
10 FT PATCH RUNNING WEIGHT	285.37
EA. ADDITIONAL 10 FT. LGTH ADD	192

SETTING TOOL OPTIONS:

HYDRAULIC			WEIGHT (LBS)
3-1/8 INCH HYDRAULIC	SET-3125-010		300
	SCREEN SUB	TT0798-288A	
	CIRCULATION SUB	SET-2875-010	
	DUMP SUB	OT0710-288B-000	

PYROTECHNIC			WEIGHT (LBS)
3-1/4 INCH MULTISTAGE SETTING TOOL	SET-3250-000		206
	POWER CHARGE	OPC-3250-000-MS	
	IGNITER	DET-5306-074	
		DET-5306-008	