

**TECHNICAL
INFORMATION:**

GTX-7000-0322-1001, 7.0 INCH 32.2 PPF



CASING O.D. (in)	7.000
CASING WT. (lb/ft)	32.2
CASING I.D. (in)	6.094
PATCH MAX. RUNNING O.D. (in)	5.870
PATCH I.D. AFTER SETTING (in)	4.892
PATCH DRIFT I.D. (in)	4.767
BURST HYDRAULIC RATING (psi)	7000
COLLAPSE HYDRAULIC RATING (psi)	7000
BURST GAS RATING (psi)	5000
COLLAPSE COLLAPSE RATING (psi)	5000

QTY.	DESCRIPTION	PART NUMBER	MATERIAL
1	GTX-SPAN SYSTEM	GTX-7000-0322-1001	NOTED
4	ELASTOMER	GTX-7000-0322-6000	HSN
1	PIN ELEMENT	GTX-7000-0322-1210	L-80
1	BOX ELEMENT	GTX-7000-0322-1410	L-80
1	TOP SWAGE	GTX-7000-0322-1110	4140 / 4142
1	BOTTOM SWAGE	GTX-7000-0322-1310	4140 / 4142
1	O-RING	OOO-V569-159	VITON
1	O-RING	OOO-V569-1595	VITON
1	72K SHEAR STUD	PAT-4500-038	4140 / 4142
1	10 FT SECTION	GTX-7000-0322-1010	L-80
-	5 FT SECTION	GTX-7000-0322-1005	L-80
-	2 FT SECTION	GTX-7000-0322-1005	L-80

MINIMUM EQUIPMENT REQUIRED FOR A FULL SYSTEM CONSISTS OF ONE SHORT ASSEMBLY AND ONE SECTION.

PRODUCT OFFERINGS:

GTX-SPAN provides a gas tight system to the industry which is effective, reliable, and economical. The system is durable and dependable as an isolation method of perforations, splits, corrossions or leaks in most types of tubulars. This system as well as our current X-SPAN[®] System can be designed using premium alloys for extreme well bore environments and custom sized for most tubing restrictions.

BENEFITS/CAPABILITIES:

- Economical and reliable solution for water shut-off / zonal isolation
- Large bore assures easy passage of service tools
- Minimal surface equipment and one trip system results in savings
- Well interventions may be performed on flowing or static wells
- Easily deployed using a range of pyrotechnic multistage or hydraulic setting tools

TECHNICAL INFORMATION:

GTX-7000-0322-1001, 7.0 INCH 32.2 PPF

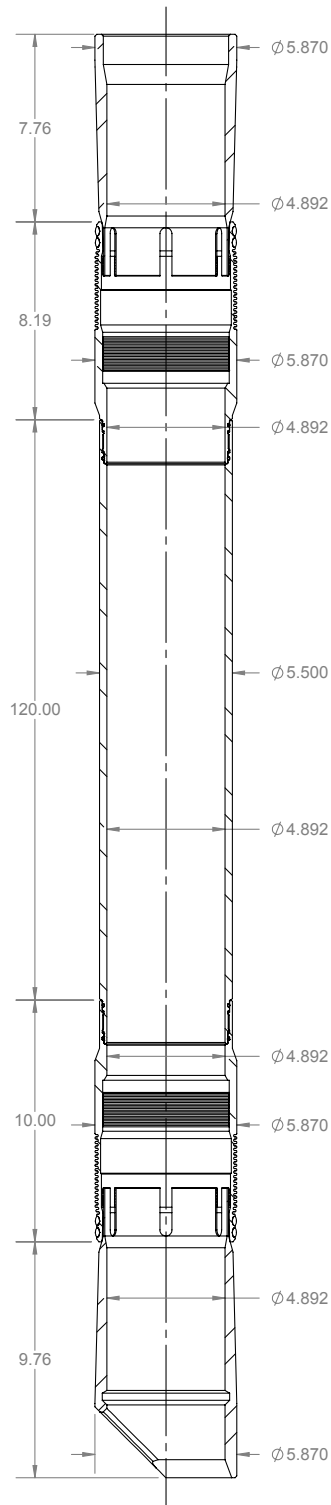

CASING O.D. (in)	7.000
CASING WT. (lb/ft)	32.2
CASING I.D. (in)	6.094
PATCH MAX. RUNNING O.D. (in)	5.870
PATCH I.D. AFTER SETTING (in)	4.892
PATCH DRIFT I.D. (in)	4.767
BURST HYDRAULIC RATING (psi)	7000
COLLAPSE HYDRAULIC RATING (psi)	7000
BURST GAS RATING (psi)	5000
COLLAPSE COLLAPSE RATING (psi)	5000

QTY.	DESCRIPTION	PART NUMBER	MATERIAL
4	ELASTOMER	GTX-7000-0322-6000	HSN
1	PIN ELEMENT	GTX-7000-0322-1210	L-80
1	BOX ELEMENT	GTX-7000-0322-1410	L-80
1	TOP SWAGE	GTX-7000-0322-1110	4140 / 4142
1	BOTTOM SWAGE	GTX-7000-0322-1310	4140 / 4142
N+1	O-RING	OOO-V569-159	VITON
N+1	O-RING	OOO-V569-1595	VITON
1	72K SHEAR STUD	PAT-4500-038	4140 / 4142
1	SET SCREW 1/4 INCH X 20 TPI, 5/16 INCH	PUR-0501-030	ALLOY
N	10 FT SECTION	GTX-7000-0322-1010	L-80
1	SLEEVE NUT	SET-3250-120	4130 / 4140
1	SLEEVE LOCK NUT	SET-3250-121	4130 / 4140
1	SETTING SLEEVE	SET-3250-383	N/A
1	QUICK CHANGE ROD	SET-3250-130	4130 / 4140
1	QUICK CHANGE NUT	SET-3250-131	4130 / 4140
1	LOCK NUT	SET-3500-025	1213 / 1215
1	TOP ADAPTER ROD	SET-3250-132	4130 / 4140
N+1	ROD TANDEM CONNECTOR	SET-3250-133	4130 / 4140
N	10 FT. ROD	SET-3250-134	4130 / 4140
OPT	5 FT. ROD	SET-3250-135	4130 / 4140
1	BOTTOM ROD EXTENDED	SET-3250-136L	4130 / 4140
1	COLLET ASSEMBLY	SET-3250-322	NOTED
1	COLLET END SUB	SET-3250-321	4140 / 4142
1	COLLET BODY	SET-3250-320	4140 / 4142
1	COLLET SUPPORT	SET-3250-323	4140 / 4142
N	ROD SUPPORT	SET-3250-296	ALUMINUM

MINIMUM EQUIPMENT REQUIRED FOR 10 FT. SYSTEM

EXTENSION SPECIFICATIONS:

GTX-7000-0322-1001, 7.0 INCH 32.2 PPF

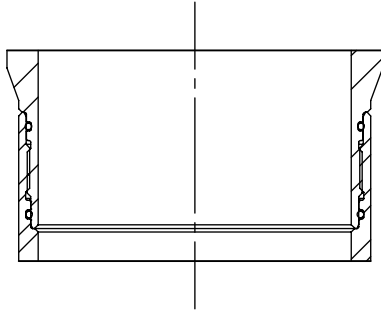

PART NUMBER	LENGTH (INCHES)	OAL (INCHES)	WEIGHT (LBS.)	MATERIAL
GTX-7000-0322-1010	120	121.8	165.5	L-80
GTX-7000-0322-1005	60	61.8	82.8	L-80
GTX-7000-0322-1002	24	25.8	33.1	L-80

PATCH TENSILE RATING	164,000 LBF.
----------------------	--------------

SYSTEM WEIGHTS

	WEIGHT (LBS.)
GTX-7000-0322-1001	56.8
10 FT PATCH RUNNING WEIGHT	355.2
EA. ADDITIONAL 10 FT. LGTH ADD	227.5

SETTING TOOL OPTIONS:

HYDRAULIC			WEIGHT (LBS)
4-1/2 INCH HYDRAULIC	SET-4500-010		880
3-1/8 INCH HYDRAULIC	SET-3125-010		300
3-1/4 INCH MULTISTAGE SETTING TOOL INTERNALLY STROKED (HYDRAULIC)	SET-3250-410		287
	SCREEN SUB	TT0798-288A	
	CIRCULATION SUB	SET-2875-010	
	DUMP SUB	OT0710-288B-000	

PYROTECHNIC			WEIGHT (LBS)
3-1/4 INCH MULTISTAGE SETTING TOOL	SET-3250-000		206
3-1/4 INCH MULTISTAGE SETTING TOOL INTERNALLY STROKED	SET-3250-400		200
	POWER CHARGE	OPC-3250-000-MS	
	IGNITER	DET-5306-074	
		DET-5306-008	
4-1/2 INCH MULTISTAGE SETTING TOOL	SET-4500-000		700
	POWER CHARGE	JEC-0450-140	
	IGNITER	DET-5306-074	
		DET-5306-008	