

TECHNICAL INFORMATION:

GTX-9625-0535-1002



CASING O.D. (in)	9.625
CASING WT. (lb/ft)	53.5
CASING I.D. (in)	8.535
PATCH MAX. RUNNING O.D. (in)	8.300
PATCH I.D. AFTER SETTING (in)	7.500
PATCH DRIFT I.D. (in)	7.375
BURST HYDRAULIC RATING (psi)	3500
COLLAPSE HYDRAULIC RATING (psi)	3500
BURST GAS RATING (psi)	3500
COLLAPSE GAS RATING (psi)	3500

QTY.	DESCRIPTION	PART NUMBER	MATERIAL
	GTX-SPAN SYSTEM	GTX-9625-0535-1002	NOTED
4	RUBBER ELASTOMER	GTX-9625-0535-6000	HSN
1	PIN ELEMENT	GTX-9625-0535-1211	4140
1	BOX ELEMENT	GTX-9625-0535-1411	4140
1	TOP SWAGE	GTX-9625-0535-1111	4140 / 4142
1	BOTTOM SWAGE	GTX-9625-0535-1311	4140 / 4142
2	O-RING	OOO-V569-170	VITON
1	105K SHEAR STUD	PAT-9625-072	4140
1	10 FT SECTION	PAT-9625-0535-1010	L-80
	5 FT SECTION	PAT-9625-0535-1005	L-80

MINIMUM EQUIPMENT REQUIRED FOR A FULL SYSTEM CONSISTS OF ONE SHORT ASSEMBLY AND ONE SECTION.

PRODUCT OFFERINGS:

GTX-SPAN provides a gas tight system to the industry which is effective, reliable, and economical. The system is durable and dependable as an isolation method of perforations, splits, corrossions or leaks in most types of tubulars. This system as well as our current X-SPAN[®] System can be designed using premium alloys for extreme well bore environments and custom sized for most tubing restrictions.

BENEFITS/CAPABILITIES:

- Economical and reliable solution for water shut-off / zonal isolation
- Large bore assures easy passage of service tools
- Minimal surface equipment and one trip system results in savings
- Well interventions may be performed on flowing or static wells
- Easily deployed using a range of pyrotechnic multistage or hydraulic setting tools

TECHNICAL
INFORMATION:

GTX-9625-0535-1002

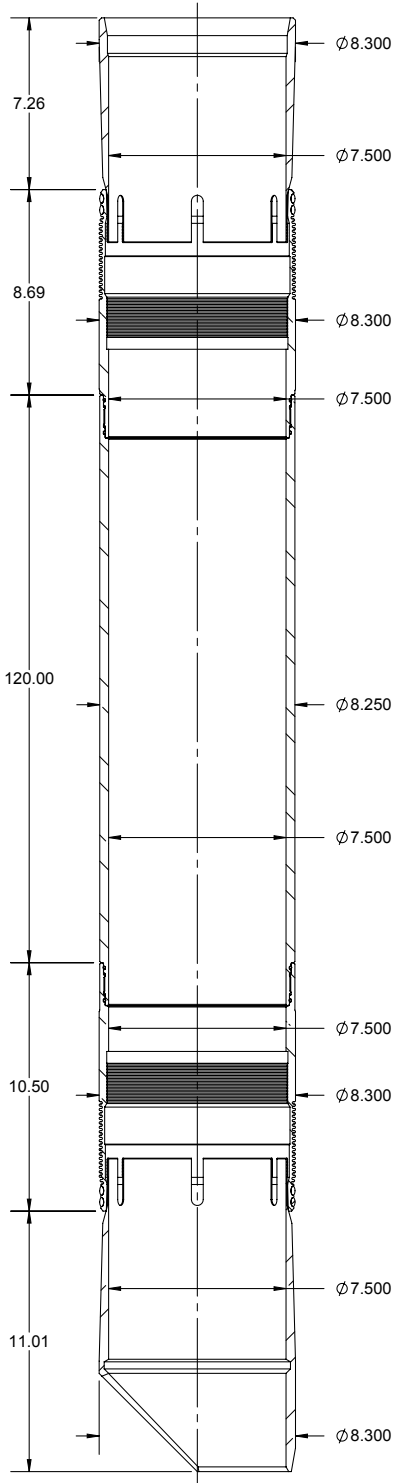

CASING O.D. (in)	9.625
CASING WT. (lb/ft)	53.5
CASING I.D. (in)	8.535
PATCH MAX. RUNNING O.D. (in)	8.300
PATCH I.D. AFTER SETTING (in)	7.500
PATCH DRIFT I.D. (in)	7.375
BURST HYDRAULIC RATING (psi)	3500
COLLAPSE HYDRAULIC RATING (psi)	3500
BURST GAS RATING (psi)	3500
COLLAPSE GAS RATING (psi)	3500

QTY.	DESCRIPTION	PART NUMBER	MATERIAL
4	RUBBER ELASTOMER	GTX-9625-0535-6000	HSN
1	PIN ELEMENT	GTX-9625-0535-1211	4140
1	BOX ELEMENT	GTX-9625-0535-1411	4140
1	TOP SWAGE	GTX-9625-0535-1111	4140 / 4142
1	BOTTOM SWAGE	GTX-9625-0535-1311	4140 / 4142
N+2	O-RING	OOO-V569-170	VITON
1	105K SHEAR STUD	PAT-9625-072	4140
1	SET SCREW 1/4 INCH X 20 TPI, 5/16 INCH	PUR-0501-030	ALLOY
N	10 FT SECTION	PAT-9625-0535-1010	L-80
1	SETTING SLEEVE	SET-4500-032A	4130 / 4140
1	SLEEVE LOCK NUT	SET-4500-033	4130 / 4140
1	SETTING SLEEVE	SET-4500-241	4140 / 4142
1	QUICK CHANGE ROD	SET-3250-130	4130 / 4140
1	QUICK CHANGE NUT	SET-3250-131	4130 / 4140
1	TOP ADAPTER ROD	SET-3250-132	4130 / 4140
N+1	ROD TANDEM CONNECTOR	SET-3250-133	4130 / 4140
N	10 FT. ROD	SET-3250-134	4130 / 4140
OPT	5 FT. ROD	SET-3250-135	4130 / 4140
1	BOTTOM ADAPTER ROD	SET-3250-217	4130 / 4140
1	COLLET ASSEMBLY	SET-3250-530	NOTED
	COLLET BODY	SET-3250-532	4130 / 4140 / 4142
	END SUB	SET-3250-226	4130 / 4140 / 4142
1	COLLET SUPPORT	SET-3250-227	4143 / 4140
N	ROD SUPPORT	SET-3250-238	ALUMINIUM

MINIMUM EQUIPMENT REQUIRED FOR 10 FT. SYSTEM

EXTENSION SPECIFICATIONS:

GTX-9625-0535-1002

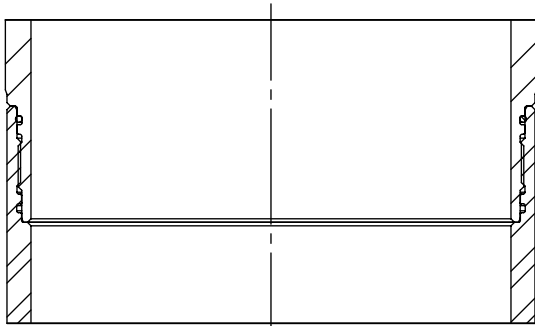

PART NUMBER	LENGTH	OAL	WEIGHT	MATERIAL
PAT-9625-0535-1010	120	121.8	315.5	L-80
PAT-9625-0535-1005	60	61.8	157.7	L-80

PATCH TENSILE RATING	255,000
----------------------	---------

SYSTEM WEIGHTS

	WEIGHT (LBS.)
GTX-9625-0535-1002	78.5
10 FT PATCH RUNNING WEIGHT	641.5
EA. ADDITIONAL 10 FT. LGTH ADD	337.5

SETTING TOOL OPTIONS:

HYDRAULIC			WEIGHT (LBS)
4-1/2 INCH HYDRAULIC	SET-4500-010		880
3-1/8 INCH HYDRAULIC	SET-3125-010		300
	SCREEN SUB	TT0798-288A	
	CIRCULATION SUB	SET-2875-010	
	DUMP SUB	OT0710-288B-000	

PYROTECHNIC			WEIGHT (LBS)
3-1/4 INCH MULTISTAGE SETTING TOOL	SET-3250-000		206
	POWER CHARGE	OPC-3250-000-MS	
	IGNITER	DET-5306-074	
		DET-5306-008	