

**TECHNICAL INFORMATION:**

**PAT-4000-0094-3001, 4.0 INCH OD 9.4-9.5 PPF**

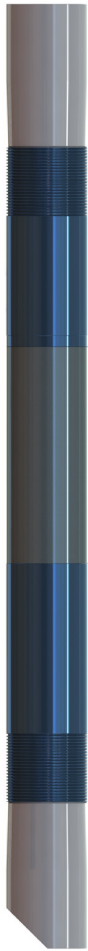

CASING O.D. (in)	4.000
CASING WT. (lb/ft)	9.5
CASING I.D. (in)	3.548
PATCH MAX. RUNNING O.D. (in)	3.430
PATCH I.D. AFTER SETTING (in)	2.992
PATCH DRIFT I.D. (in)	2.867
BURST HYDRAULIC RATING (psi)	5000
COLLAPSE HYDRAULIC RATING (psi)	5500

QTY.	DESCRIPTION	PART NUMBER	MATERIAL
1	X-SPAN SYSTEM	PAT-4000-0094-3001	NOTED
4	GTX ELASTOMER	GTX-4000-0094-6000	HSN
1	PIN ELEMENT	PAT-4000-0094-3210	13 Cr L-80
1	BOX ELEMENT	PAT-4000-0094-3410	13 Cr L-80
1	TOP SWAGE	PAT-4000-0094-3110	SUPER \ HYPER 13 Cr
1	BOTTOM SWAGE	PAT-4000-0094-3310	SUPER \ HYPER 13 Cr
1	O-RING	OOO-V569-150	VITON
1	O-RING	OOO-V569-1517	VITON
1	30K SHEAR RING	PAT-2875-048A	STL-12L4-150
1	10 FT. SECTION	PAT-4000-0094-3010	13 Cr L-80
		PAT-4000-0094-1010	L-80
	5 FT. SECTION	PAT-4000-0094-3005	13 Cr L-80
		PAT-4000-0094-1005	L-80

MINIMUM EQUIPMENT REQUIRED FOR A FULL SYSTEM CONSISTS OF ONE SHORT ASSEMBLY AND ONE SECTION.

**PRODUCT OFFERINGS:**

The Owen X-SPAN® System is an economical, proven, durable and dependable sealing system for the isolation of perforations, splits, corrosion or leaks in all types of tubulars and conditions. This system can utilize a multitude of deployment methods in all types of well bores. The large bore assures easy passage of service tools including bridge plugs, drop balls, seal bore assemblies, logging tools and perforating systems. The minimal surface equipment required for deploying the patch and rig less intervention results in significant savings for the operator.

**BENEFITS/CAPABILITIES:**

The X-SPAN® System Offers:

- A proven, durable and dependable seal
- Deployment on electric wireline, tubing, drill pipe or coil tubing in vertical, deviated or horizontal or geothermal well bores
- An economical and reliable solution for a broad range of applications
- A large bore for easy passage of service tools
- Minimal surface equipment required for deployment

**TECHNICAL INFORMATION:**

**PAT-4000-0094-3001, 4.0 INCH OD 9.4-9.5 PPF**

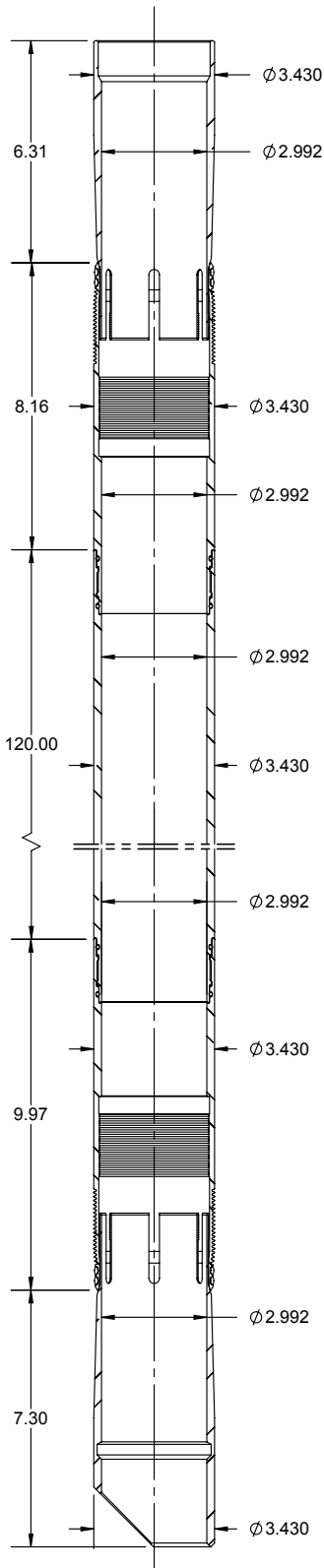

CASING O.D. (in)	4
CASING WT. (lb/ft)	9.5
CASING I.D. (in)	3.548
PATCH MAX. RUNNING O.D. (in)	3.430
PATCH I.D. AFTER SETTING (in)	2.992
PATCH DRIFT I.D. (in)	2.867
BURST HYDRAULIC RATING (psi)	5000
COLLAPSE HYDRAULIC RATING (psi)	5500

QTY.	DESCRIPTION	PART NUMBER	MATERIAL
4	GTX ELASTOMER	GTX-4000-0094-6000	HSN
1	PIN ELEMENT	PAT-4000-0094-3210	13 Cr L-80
1	BOX ELEMENT	PAT-4000-0094-3410	13 Cr L-80
1	TOP SWAGE	PAT-4000-0094-3110	SUPER \ HYPER 13 Cr
1	BOTTOM SWAGE	PAT-4000-0094-3310	SUPER \ HYPER 13 Cr
N+1	O-RING	OOO-V569-150	VITON
N+1	O-RING	OOO-V569-1517	VITON
1	30K SHEAR RING	PAT-2875-048A	STL-12L4-150
N	10 FT. SECTION	PAT-4000-0094-3010	13 Cr L-80
1	SLEEVE NUT	SET-2687-130	4140 / 4142
1	SLEEVE LOCK NUT	SET-2125-121	4140 / 4142
1	SETTING SLEEVE ASSEMBLY	SET-2687-402	SEE TABLE
1	QUICK CHANGE ROD	SET-2125-130	4340
1	QUICK CHANGE NUT	SET-2125-131	4130 / 4140 / 4142
1	TOP ADAPTER ROD	SET-2125-132	4130 / 4140 / 4142
N+1	ROD TANDEM CONNECTOR	SET-2125-133	4130 / 4140 / 4142
N	10 FT. ROD	SET-2125-134	4130 / 4140 / 4142
OPT	5 FT. ROD	SET-2125-135	4130 / 4140 / 4142
1	BOTTOM ROD	SET-2125-136	4130 / 4140 / 4142
1	COLLET ASSEMBLY	SET-2687-338	NOTED
1	END SUB	SET-2687-433	4130 / 4140 / 4142
1	COLLET	SET-2687-337	4130 / 4140 / 4142
1	COLLET SUPPORT	SET-2687-405	4130 / 4140 / 4142

MINIMUM EQUIPMENT REQUIRED FOR 10 FT. SYSTEM

**EXTENSION SPECIFICATIONS:**

**PAT-4000-0094-3001, 4.0 INCH OD 9.4-9.5 PPF**

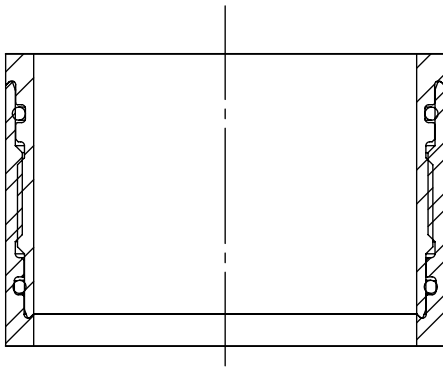

PART NUMBER	LENGTH (INCHES)	OAL (INCHES)	WEIGHT (LBS.)	MATERIAL
PAT-4000-0094-3010	120	121.79	73.7	13 Cr L-80
PAT-4000-0094-1010	120	121.79	73.7	L-80
PAT-4000-0094-3005	60	61.79	36.9	13 Cr L-80
PAT-4000-0094-1005	60	61.79	36.9	L-80

PATCH TENSILE RATING	45,000 LBF
----------------------	------------

**SYSTEM WEIGHTS:**

	WEIGHT (LBS.)
PAT-4000-0094-3001	15.4
10 FT PATCH RUNNING WEIGHT	142.7
EA. ADDITIONAL 10 FT. LGTH ADD	101.9

**SETTING TOOL OPTIONS:**

HYDRAULIC			WEIGHT (LBS)
SET-2687-200	2-11/16 HYDRAULIC		150
	SCREEN SUB	OTO-798-288A	
	CIRCULATION SUB	SET-2875-010	
	DUMP SUB	SET-2125-200	

PYROTECHNIC			WEIGHT (LBS)
SET-2687-101	2-11/16 MSST		90
	POWER CHARGE	JEC-5334-104	
		JEC-0212-044	
	IGNITER	DET-5306-074	
		DET-5306-008	