

APPLICATION / OPERATION

The Owen Type "B" Wireline Set Frac Plug is a compact unit designed expressly for multi zone fracturing of gas wells.

The plug is constructed of easily drillable cast iron and uses just one slip and cone to hold the frac pressure above the plug. A large diameter bore extends through the plug and a beveled entry is provided as a seat for the plastic bridging ball. The bottom of the plug is notched to allow lower zone gas flow even when the bridging ball of a frac plug set below has flowed up to the bottom of the plug.

The plug is easily made up on a pressure setting tool. Attach the setting sleeve and setting rod to the setting tool. Remove the bottom guide of the frac plug to expose the brass shear screws at the bottom of the plug then slide the plug on the setting rod. Screw the shear screws in a groove provided on the setting rod then re-attach the bottom guide to the plug.

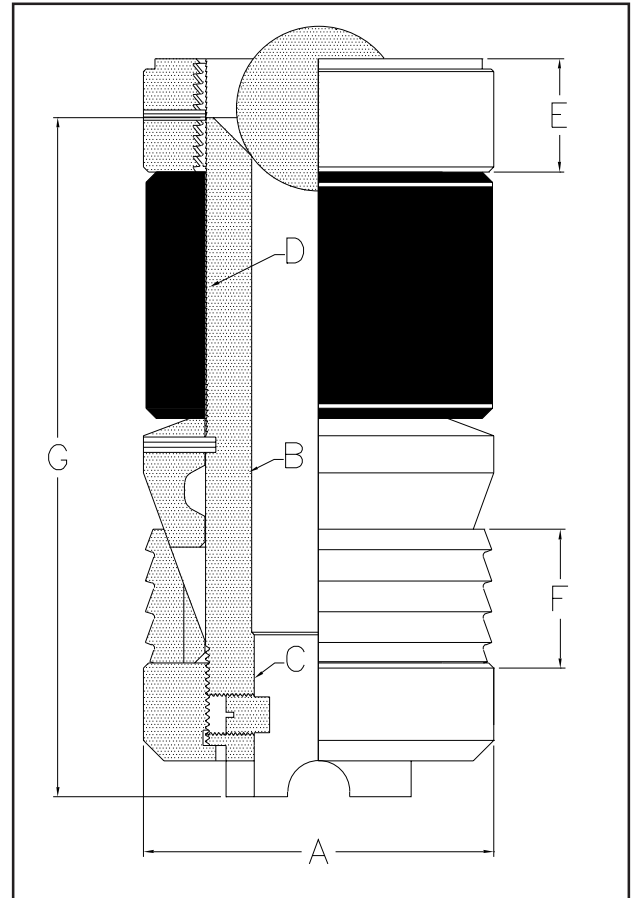

SPECIFICATIONS

Casing		Type "B" Frac Plug Part No.	Plug O.D.	Setting Range		Setting Force (lbs)	Owen 3-1/2" Setting Adapters		Baker Setting Adapters	
O.D.	Weight			Min.	Max.		Setting Sleeve	Adapter Rod	Setting Sleeve	Adapter Rod
5-1/2	14-25	PLG-4240-060	4.24	4.580	5.012	30,000	SET-5307-081	SET-5303-114	SET-5307-217 No. 10	SET-5307-252 No. 10
									SET-5307-163 No.20	SET-5303-142 No.20

DIMENSIONAL DATA (INCHES)

Plug Part No.	A	B	C	D	E	F	G	BALL DIA.
PLG-4240-060	4.24	1.63	1.56	2.75	1.38	1.62	8.25	2.00