

Specifications

| Tubular Collar No-Go | | |
|----------------------|-----|----------------------------------|
| Part No. | Qty | Description |
| TC-170-2375-000 | 1 | 2-3/8 in EUE No-Go (1.575 in ID) |
| TC-170-2875-000 | 1 | 2-7/8 in EUE No-Go (1.575 in ID) |
| TC-170-3500-000 | 1 | 3-1/2 in EUE No-Go (1.575 in ID) |

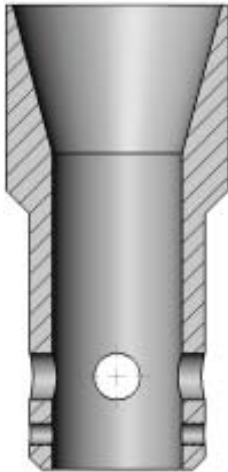

Specifications

| Impact Firing Head No-Go | | |
|--------------------------|-----|---|
| Part Number | Qty | Description |
| TC-010-0022-110 | 1 | Impact Firing Head No-Go for 2-3/8 EUE (1.395 ID) |
| TC-010-0029-110 | 1 | Impact Firing Head No-Go for 2-7/8 EUE (1.395 ID) |
| TC-010-0030-110 | 1 | Impact Firing Head No-Go for 3-1/2 EUE (1.395 ID) |

The Impact Firing Head No-Go uses either one or two, 1/4 - 28 - 1/4 large cup point set screws to secure to the Firing Impact. Part Number PF-001-025F-025 (PUR-0504-027)